

Our largest volume discounts ever on 2024 models

Hurry before they are gone!

**Over 50 RVs
inside/heated
Free Admission**



**Door Prizes!
win up to \$500
shopping spree!!!**

2024 Model In-House RV Show

**2023
liquidation**

3 BIG WEEKENDS

Thursday-Saturday • 9AM-6PM

Jan. 25-27 • Feb. 1-3 • Feb. 29-March 2

**NO
PAYMENTS
UNTIL MAY**

"It's great to be back in the RV Industry with this team!!"

Brad and Brandy Thompson



over 400 years of RV experience



DARE TO COMPARE BEFORE YOU BUY

- ✓ family owned and over 400 years of combined RV experience
- ✓ Best Brands, Floorplans & pricing on 2024 RVs
- ✓ No pressure, transparent sales process = easiest way to buy
- ✓ Dealer reputation - ask other or check reviews-see why Premier RV is "what customers want and deserve."



Sunray109
1,320 lbs.

\$11,991

***\$127
per month**

Aluminum Exterior



Starcraft Autumn Ridge 26BH 4,840 lbs.

\$19,991

****\$189
per month**



Arcadia Select 5th Wheel 21SRK 6,850 lbs.

\$37,991

*****\$329
per month**

746 Industrial Drive, Blue Grass, Iowa 52726 • 563-424-7788 • www.premierrv.com

Prices good thru 3-2-24 or until supplies last.

Not responsible for printing errors.

[Facebook.com/PremierRVIowa](https://www.facebook.com/PremierRVIowa)

Thompsons Continue the Family Legacy with Premier RV

ADVERTORIAL— Brad Thompson is no stranger to selling RVs. In fact, it's been a part of his life since he was a child. Brad's parents, Jim and Darlene Thompson, owned and operated an RV dealership for decades before passing ownership on to Brad and his four siblings. The siblings, Mark (Dawn) Thompson, Tim (Brenda Thompson), Jill (Larry) Tappendorf, and Ann (Paul) Thorndyke sold the business five years ago. Brad and his wife, Brandy, decided they weren't finished with the RV industry. In October 2021, the couple opened up their own dealership, Premier RV, in Blue Grass. The company prides itself on offering customer care that can't be found at the big box dealers. "We came up with a model when we started of what customers want & deserve. Every decision, we have that in mind," Thompson said.

Culture is important to the Thompsons, which led them to bring on many people who worked for their previous business. Nearly 80% of their current staff also worked at the previous family dealership. The team collectively has over 400 years of RV industry experience.



Premier RV sales team



We predetermine our lowest possible selling price and post it on selected RV models. It enables our sales team to spend more time focusing on the needs of our guests. Our prices are based on inventory levels, market analysis, huge volume discounts, and fully prepped out RVs with full factory warranties, all at the lowest prices in the country. This means NO haggling, gimmicks, high pressure, "make me an offer," "today only," or back and forth to management; just a stress free way to buy. Trade-ins would be gladly accepted on Super Value priced units at market values.

PREMIER RV 2023 TT BLOWOUT

2023 Intech-Flyer



Pursue #1552
\$17,991 ****\$169**
per month

2023 Sonic Lite



SL169VUD #1536
\$23,981 ****\$226**
per month

2023 Sportsmen Classic



160QB #1729
\$14,961 ***\$157**
per month

2023 Sol



Dawn #1570
\$29,981 *****\$250**
per month

2023 Sportsmen Classic



170MB #1484
\$15,991 ***\$166**
per month

2023 Sonic



SN211VDB #1521
\$28,991 ****\$273**
per month

2023 Super Lite



225CK #1576
\$27,991 ****\$263**
per month

2023 Super Lite



225CK #1685
\$28,491 ****\$267**
per month

2023 Super Lite



252RB #1591
\$28,991 ****\$272**
per month

2023 Super Lite



262RL #1775
\$27,981 ****\$263**
per month

*Financing figured with 15% down plus tax, title and license WAC for 120 Months at 8.49% **Financing figured with 15% down plus tax, title and license WAC for 144 Months (Some inventory over \$50,000 may qualify for 240 months) at 8.49%
Financing figured with 15% down plus tax, title and license WAC for 180 Months at 8.49%. *Financing figured with 15% down plus tax, title and license WAC for 240 Months at 8.49%. See your sales associates for more details*

PREMIER RV 2023 TT BLOWOUT

2023 Ember Touring Edition



26MRB #1526

\$44,991 ***\$376 per month

2023 Autumn Ridge



26BHS #1587

\$25,991 ***\$245 per month

2023 SportTrek



ST327VIK #1671

\$45,991 ***\$384 per month

2023 SportTrek Tour



STT272VRK #1541

\$39,981 ***\$334 per month

2023 SportTrek Tour



STT272VRK #1699

\$41,981 ***\$352 per month

2023 Autumn Ridge



28BHS #1583

\$29,991 ***\$293 per month

2023 Ember Touring Edition



28MBH #1524

\$46,991 ***\$393 per month

2023 Stratus



SR281VFD #1412

\$34,921 ***\$292 per month

2023 Starcraft GSL



290RLS #1770

\$42,995 ***\$359 per month

2023 SportTrek Touring



STT302VRB #1681

\$49,991 ***\$418 per month

2023 Sportsmen 5th Wheel



231RK #1645

\$36,991 ***\$309 per month

2023 Starcraft Light 5th Wheel



234RLS #1735

\$39,991 ***\$336 per month

2023 Arcadia Super Lite 5th Wheel



253SLRD #1664

\$45,991 ***\$383 per month

2023 Arcadia Super Lite 5th Wheel



292SLRL #1660

\$54,991 ***\$460 per month

2023 Arcadia Super Lite 5th Wheel



292SLRL #1662

\$54,991 ***\$460 per month

2023 Sprinter Limited 5th Wheel



3190RLS #1615

\$52,921 ***\$443 per month

2023 Sprinter Limited 5th Wheel



3190RLS #1617

\$52,921 ***\$443 per month

2023 Avalanche 5th Wheel



360 FL #1623

\$67,991 ***\$569 per month

2023 Avalanche 5th Wheel



390DS #1757

\$73,991 ***\$618 per month

*Financing figured with 15% down plus tax, title and license WAC for 120 Months at 8.49% **Financing figured with 15% down plus tax, title and license WAC for 144 Months (Some inventory over \$50,000 may qualify for 240 months) at 8.49% ***Financing figured with 15% down plus tax, title and license WAC for 180 Months at 8.49%. ****Financing figured with 15% down plus tax, title and license WAC for 240 Months at 8.49%. See your sales associates for more details*

2024 Sportsmen Classic/SE



Sportsmen 130RB 2,190 lbs.

\$14,991

***\$158**
per month



Sportsmen 180BH 2,690 lbs.

\$15,991

***\$169**
per month



Sportsmen 191BHK 3,490 lbs.

\$19,991

****\$189**
per month



Sportsmen 181 BH 3,180 lbs.

\$19,291

****\$182**
per month



Sportsmen 241RKSE 5,500 lbs.

\$28,891

****\$273**
per month



2024 Sportsmen SE Advantages over the Competition

- Made by Thor Industries- #1 manufacturer of RVs in the World
- Lumber Core Style Cabinetry vs competition pressboard
- Forced Air Heated Underbelly with insulated floor vs competitions only enclosed underbelly no insulated floor
- True 2x2 studded walls and roof trusses on 16" center vs competitions 1 1/2" walls
- Fiberglass wall insulation glued in place allowing it not to settle and cause insulations gaps
- 500 pound weight rated on double bunks (cargo/sleeping)
- More windows that open in most models vs the competition
- Full bedroom wall with sliding door on most bunk models versus competitions curtains.
- 80 pound cabinet drawer ratings
- Gas furnace standard
- Larger exterior storage doors
- Magnetic Catches for Baggage Doors
- Battery Disconnect Switch

2024 Sunset Park Trailers



Sunlite13BD LTD

1,320 lbs.

\$14,991

***\$158**
per month

Teardrop

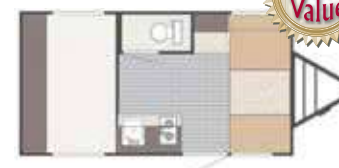

Sunray149

2,260 lbs.

\$15,991

***\$169**
per month



Sunray109

1,320 lbs.

\$11,991

***\$127**
per month



Sunlite16BH

2,490 lbs.

\$16,991

***\$179**
per month

*Financing figured with 15% down plus tax, title and license WAC for 120 Months at 8.49% **Financing figured with 15% down plus tax, title and license WAC for 144 Months (Some inventory over \$50,000 may qualify for 240 months) at 8.49%
Financing figured with 15% down plus tax, title and license WAC for 180 Months at 8.49%. *Financing figured with 15% down plus tax, title and license WAC for 240 Months at 8.49%. See your sales associates for more details*

2024 Starcraft Autumn Ridge

most with fiberglass exterior,
TV, enclosed heated underbelly
+ 3 yr. structural warranty



2024 Starcraft Autumn Ridge Advantages

- 2 – 30# lp tanks vs competitions 20# (dual axle models)
- Every window opens vs competitions any Port windows
 - All windows are tinted and safety glass
 - Window in the entry door
 - Upgraded wooden trim around windows with top valance
- All large slideouts are flush floor and use linoleum vs competition carpet
- Xtend Solar I Package: 200 watt solar panel with 30 amp controller
- More cabinets than any of our competition in like floor plans
 - Modern hardware, strong-hold latches, and no-slip lips in all the cabinets enhance convenience.
 - Large bathroom medicine cabinets vs competition no storage mirror (dual axle models)
 - Most bathroom counter space and cabinet space then the competitions
 - at least 2 drawers in every kitchen Starcraft builds
 - Solid master bedroom doors vs competition curtains (26BH model has half wall with others are open)
 - Large mirrored bedroom wardrobe closets with nightstands with outlets/chargers
 - Decorative front bedroom wall panel
- large single-basin sink (stainless steel on dual axle models) and sleek pressed membrane countertops vs competition small bowl
- Large 10.2 cubic Everchill 12V refrigerators with doors that swing either direction
- Decorative kitchen backsplash vs competitions wall board
- 40" wide dinette vs competition 32"
- Heaviest Rated bunks in the industry- Single bunks are a 300# Rating Double bunks are 600#
- Front queen bed have plywood base with struts – storage underneath is separated from exterior storage to keep dirt out
- Premium main bed comforter (most models)
- Tough rotocast Holding tanks
- Larger Fresh tanks – 48 gallons vs competitions 40 gallon (dual axle models)
- Larger Black tanks – 39 gallons vs competitions 28 gallons (dual axle models)
- Safety slam friction hinge entrance door
- Power Tongue jack (dual axle models)
- 6 gallon g/e water heaters STD (even on single axle models)
- 1 year manufacturers warranty with a 3 yr. structural warranty



Starcraft Autumn Ridge 182RB 3,465 lbs.

\$17,991 ****\$170**
per month



Starcraft Autumn Ridge 19BH 3,565 lbs.

\$17,991 ****\$170**
per month



Starcraft Autumn Ridge 188BHS 4,245 lbs.

\$21,991 ****\$208**
per month



Starcraft Autumn Ridge 20MB 4,305 lbs.

\$20,991 ****\$198**
per month



Starcraft Autumn Ridge 20FBS 5,880 lbs.

\$21,991 ****\$205**
per month
with fiberglass **\$23,991** ****\$227**
per month



Starcraft Autumn Ridge 26BH 4,840 lbs.

\$19,991 ****\$189**
per month
with fiberglass **\$21,991** ****\$205**
per month



Starcraft Autumn Ridge 26BHS 5,810 lbs.

\$24,991 ****\$236**
per month
with fiberglass **\$26,991** ****\$253**
per month



Starcraft Autumn Ridge 26RLS 5,860 lbs.

\$26,991 ****\$253**
per month
with fiberglass **\$28,991** ****\$274**
per month

Super Lite



Super Lite 189RG 4,915 lbs.

\$28,991 ****\$274**
per month



Super Lite 233 ML 5,885 lbs.

\$33,995 *****\$289**
per month



Super Lite 252RB 6,185 lbs.

\$33,991 *****\$289**
per month

Super Lite Series offer the same advantage of the Autumn Ridge but uses Tuffshell vacuum bond construction for a lighter option.

- TuffShellIT - vacuum bonded laminated construction: Delivers a strong and lasting structure resistant to external factors. Intensive Fiberglass Bonding Process: Applies 144 tons of pressure for 16-18 minutes for complete adhesive coverage and curing.
- ¼ front fiberglass cap
- Aluminum rims
- Rear roof access ladder

*Financing figured with 15% down plus tax, title and license WAC for 120 Months at 8.49% **Financing figured with 15% down plus tax, title and license WAC for 144 Months (Some inventory over \$50,000 may qualify for 240 months) at 8.49%
Financing figured with 15% down plus tax, title and license WAC for 180 Months at 8.49%. *Financing figured with 15% down plus tax, title and license WAC for 240 Months at 8.49%. See your sales associates for more details*

2024 KZ Connect



KZ Connect 241RLK 5,810 lbs.

\$36,991 ***\$310 per month



KZ Connect 282FKK 7,260 lbs.

\$45,990 ***\$385 per month



KZ Connect 241RESE 5,630 lbs.

\$30,991

***\$260 per month



KZ Connect 262RLK 6,890 lbs.

\$43,900 ***\$368 per month



KZ Connect 302RBK 7,680 lbs.

\$45,900 ***\$384 per month

2024 KZ Connect Advantages

- Over 50 years of experience
- Backed by Thor Industries – the #1 manufacturer in the industry
- True 2-year manufacturer warranty vs one year with competitor's
- 3-year structural warranty
- 1-piece, seamless, Tufflex roofing material w/lifetime warranty
 - o 3/8" decking allows it to be 100% walkable
 - o The 100% PVC material doesn't need a wear layer like competition's roofs
 - o High solar reflectivity
 - o Flexible and incredibly puncture resistant
- Laminated Azdel composite panels – No mold, mildew, rotting or warping
 - o 50% lighter than wood
 - o Unaffected by temperature and humidity changes
 - o Superior thermal insulation
- 5/8" tongue & groove plywood floor decking allows for a more residential style construction
- Beauflor flooring in slideouts
- Climate package includes heated and enclosed underbelly
 - o Two ways of heating the underbelly (forced and radiant) extends your season
- NXG Huck bolted & powder coated Frame
 - o American made w/ HSLA – High strength low alloy prime steel
- Nitrogen filled Goodyear tires w/aluminum wheels
- RV airflow system – 40% more efficient than standard air systems
 - o Captures 100% of the air in the ducts
 - o Consistent airflow throughout the camper – meaning your camper cools faster

This also means less time = less energy consumption
- KZ Engage: Powered by OneControl w/5" Screen control system
 - o Monitors tank levels & battery levels
 - o Controls slide rooms, leveling system, awnings, inside/outside lighting
 - o Prepped for TPMS to be added
- Hand-Crafted Mortise & Tenon cabinet doors w/ Rich Woodbridge Maple cabinetry

2024 Ember E-Series Advantages

- Ember's 1-2-3 Warranty
 - o (1) One time transferrable
 - o (2) Two-year base warranty
 - o (3) Three-year structural warranty
- Laminated Azdel Onboard® composite walls
 - o Aluminum framed sidewall construction
- Fully walkable roof w/ one-piece Tufflex® PVC Roofing (Limited Lifetime Warranty)
- Dexter® Axles W/ E-Z lube hubs & forward self-adjusting electric brakes
 - o Automatically adjusts the brake shoe during every forward stop
 - o No more adjustments every 3000 miles!
- Goodyear Endurance tires (load range E)
 - o Custom aluminum rims
- Best-in-class 82" interior ceiling height
- 18K BTU Max Cool "Whisper Quiet" AC w/ remote
 - o Largest Single AC in it's class
- Repositionable EmberTrack™ E-track bunk/ storage system
 - o 70"x45" rear cargo area w/ large side storage locker (integrated pull-down screen) & rear kayak/ bike door
- Congoleum® DiamondFlor® "Carpetless" interior
- Legless Dinette booth w/ All-In-One strut assisted conversion system
- Convection microwave w/ integrated air fryer
- EmberLink™ "Smart RV" system
 - o Controls slide room, awning & lights
- XL 55-GAL Fresh tank & 35-GAL Gray/Black Tanks
- Tankless "On Demand" water heater
- 10 CuFt 12V refrigerator
- 12V DC Smart TV w/ integrated sound bar and radio
 - o Swivel arm mounting w/ storage behind the TV
- Hardwood framed cabinet doors w/hidden residential hinges
- Soft close hardwood drawers
- Roller Blackout shades
- Porcelain foot-flush toilet
- 12V multi-speed fan w/ rain sensor & wall control
- Dimmable interior lighting & dimmable awning LED light
- Medicine cabinet w/ LED backlight
- Frame integrated 2" rear receiver w/ 300# capacity
- Repositionable/telescoping roof ladder + rear-mounted bracket
- Keyed-Alike™ Locking System
- 360 Siphon® Roof vent caps

Ember E-Series

Same great Ember quality at an amazing price



Ember 22MLQ 5,155 lbs.

\$38,995 ***\$327 per month



Ember 22ETS 5,395 lbs.

\$34,995 ***\$293 per month



Ember Overland 221MSL 5,700 lbs.

\$60,382 ***\$505 per month

Max Solar

Keystone Bullet Crossfire



Keystone Bullet 1900RD 3,510 lbs.

\$20,991 ***\$198 per month



Keystone 2530RD 5,600 lbs.

\$33,995 ***\$285 per month



Keystone 2870QB 6,400 lbs.

\$35,991 ***\$302 per month

*Financing figured with 15% down plus tax, title and license WAC for 120 Months at 8.49% **Financing figured with 15% down plus tax, title and license WAC for 144 Months (Some inventory over \$50,000 may qualify for 240 months) at 8.49% ***Financing figured with 15% down plus tax, title and license WAC for 180 Months at 8.49%. ****Financing figured with 15% down plus tax, title and license WAC for 240 Months at 8.49%. See your sales associates for more details*



2024 Stratus Advantages over the Competition

- NXG Huck bolted & powder coated frame
 - o American made w/ HSLA – High strength low alloy prime steel
- Laminated Azdel composite panels – No mold, mildew, rotting or warping
 - o 50% lighter than wood
 - o Unaffected by temperature and humidity changes
 - o Superior thermal insulation
- 5/8" tongue & groove plywood floor decking allows for a more residential style construction
- RV airflow system – 40% more efficient than standard air systems
 - o Captures 100% of the air in the ducts
 - o Consistent airflow throughout the camper – meaning your camper cools faster
 - This also means less time = less energy consumption
- Weather shield package includes heated and enclosed underbelly + 360-degree radiant foil wrap
 - o Two ways of heating the underbelly (forced and radiant) extends your season
 - o Radiant foil wrapping also includes the tanks
- 1-piece, seamless, Tufflex roofing material w/lifetime warranty
- o 3/8" decking allows it to be 100% walkable
- o The 100% PVC material doesn't need a wear layer like competition's roofs
- o High solar reflectivity
- o Flexible and incredibly puncture resistant

- LionsHead nitrogen-filled radial tires (VBF)
 - o first year "No Excuses Warranty"
 - o 2-year complimentary roadside assistance
 - o 5-year warranty on radial ST tires and lifetime structural warranty on all wheels
- Rear roof ladder
- Frameless front automotive window
- Keyed alike ONE key system for entry and baggage doors
- SafeTek box w/110V outlets and USB ports
- Heirloom maple & Antique white cabinet doors
- Level Mate Pro makes leveling your RV easy
- Seamless Live edge Surf-X counter tops
- Beauflor flooring w/7-year warranty including slide out floors
- Venture LevelMate PRO system

2024 Stratus



Stratus Sport 289VBHS

6,160 lbs.

\$31,991

***\$268
per month



Stratus 261VRB

6,490 lbs.

\$44,990

***\$377
per month

2024 SportTrek



Sporttrek 251VFK

6,190 lbs.

\$38,991

***\$327
per month

Due in March



Sporttrek Touring 292VRB

7,500 lbs.

\$56,991

***\$469
per month



Sporttrek 312VIK

7,600 lbs.

\$49,990

***\$419
per month



Sporttrek 333VIK

8,870 lbs.

\$49,991

***\$419
per month



Sporttrek 327VIK

8,180 lbs.

\$49,991

***\$419
per month



Sportsmen Touring 333VMI

8,820 lbs.

\$59,991

***\$502
per month



Sporttrek Touring 343VIK

8,870 lbs.

\$59,991

***\$502
per month



2024 SportTrek Advantages over the Competition

- Heirloom maple and antique white glazed cabinetry-most storage in its class
- ¾ fiberglass front cap with panoramic automotive front window
- 82" interior ceilings with 72" slide out heights
- Most Floorplans with outdoor kitchens
- NXG Huck Bolt, powder coated & baked frame=superior main frame
- Azdel composite exterior panels are used in place of luan plywood, thus providing less weight, better insulating properties & sound deadening, moisture resistance, and no formaldehyde
- Serta Memory Foam 60x80" full size Queen mattress w/stor mor nightstands
- Wide Trek Axles with polished aluminum rims
- Under booth storage totes
- 5/8" tongue & groove plywood floor decking (on 16" centers) vs competitors pressed wood floors
- 250 lbs. Rated frame mounted accessory receiver
- Aluminum Flip Up Steps w/Fold Away Grab Handle gaining extra safety
- Dicor "Tufflex" one piece PVC roof with lifetime warranty
- Forced air heated and enclosed tanks and waste valves
- RV Airflow System-increased AC airflow by 40%

*Financing figured with 15% down plus tax, title and license WAC for 120 Months at 8.49% **Financing figured with 15% down plus tax, title and license WAC for 144 Months (Some inventory over \$50,000 may qualify for 240 months) at 8.49%
Financing figured with 15% down plus tax, title and license WAC for 180 Months at 8.49%. *Financing figured with 15% down plus tax, title and license WAC for 240 Months at 8.49%. See your sales associates for more details*



2024 Intech RV

See why there is no comparison to the top of line, completely aluminum framed trailer



Intech Flyer Advantages

- (Class leading) Fully welded cage to the chassis to eliminate twists or structural weaknesses
- Weight friendly- cut by 1/3 using aluminum instead of steel
- One piece aluminum roof
- Spring assist ramp door (Discover & Explore)
- 11K BTU A/C with heat strip
- Modern Interior design
- 45 Degree down axel 2" more ground clearance
- Heavy duty Front Tongue Box
- Standard 2" receiver for bikes rated up to 175lbs.
- Rugged design-built for over roading adventures
- Versatile interior



2023 Flyer Pursue

1,575 lbs.

\$17,991

****\$170**
per month



Luna Rover

1,850 lbs.

\$23,991

****\$225**
per month

Intech Luna Advantages

- inTech RV's Luna is a teardrop camper
- Premium outdoor kitchen
- Signature front cap allows for a uniquely large interior and panoramic windshield (most competitors don't offer a front panoramic window)
- All-aluminum, all-tube, fully welded cage frame
- Optional Fireplace.
- Optional Cassett toilet
- Infinity Woven Flooring. Durable and easy to clean.
- 8K BTU A/C
- One Piece Fiberglass roof
- 2" Rear Receiver – 175# Capacity



Sol Dusk Rover

3,980 lbs.

\$44,900

*****\$376**
per month



Sol Horizon Rover

3,372 lbs.

\$41,991

*****\$352**
per month



Terra Magnolia

5,200 lbs.

\$59,879

*****\$501**
per month



Terra Willow Rover

5,850 lbs.

\$69,979

*****\$586**
per month

*Financing figured with 15% down plus tax, title and license WAC for 120 Months at 8.49% **Financing figured with 15% down plus tax, title and license WAC for 144 Months (Some inventory over \$50,000 may qualify for 240 months) at 8.49%
Financing figured with 15% down plus tax, title and license WAC for 180 Months at 8.49%. *Financing figured with 15% down plus tax, title and license WAC for 240 Months at 8.49%. See your sales associates for more details*

2024 GSL Fifth Wheel Advantages over the Competition

- 60 years of RV experience
- Part of the Jayco Family since 1991
- Magnum Roof System:
 - o Reinforced crowned truss roof rafters w/ 3/8" fully walkable roof decking
 - o Strength tested to 4500lbs – up to 50% stronger than the competition
 - o Screwed not stapled construction
 - o Reduced chance of fasteners coming loose & puncturing the rubber roof material
 - o 7" header beams between the roof and slide out openings
 - o Similar to load-bearing areas in home construction
 - o Thicker wood instead of aluminum – Vertical 2X2" studs
 - o Maximizes load capacity
 - o Provides smoother edges to run wiring which greatly reduces risk of electrical shorts
 - o Oversized nail plate joint fasteners attached to both sides of the trusses
 - o Tighter trusses = less chance of movement
- PVC roof membrane w/ limited lifetime warranty
- TuffShell – Vacuum bonded laminated walls reinforced w/ heavy-duty fiberglass & welded aluminum frames
 - o 144 tons of pressure applied for 18 minutes to ensure 100% adhesive coverage & curing
- Laminated Block foam floor
- 100" Wide-body construction on all GSL fifth wheels
- Equi-flex axle suspension system
 - o Brass hanger bushings w/wet bolt
- Levelloc – 4-point automatic leveling w/JT's Strong Arms
- Xtend Solar I pkg - Standard w/ 200watts of roof mounted solar & 30amp controller
- Fully enclosed underbelly w/ ducted heat & cold air return
- Enclosed exterior docking station w/ black tank flush
 - o Enclosed cable operated gate valves as well
- 10CuFt 12V Fridge
- 75Lb ball bearing drawer guides
- Flush floor slide out w/ residential vinyl flooring
- Hardwood cabinet doors and slide out fascia
- Roller blackout night shades
- 15k BTU main AC standard w/ 2nd AC prep/option
- Keyed-Alike entry and baggage doors
- Painted fiberglass front cap w/ LED lighting
- TravelLink – Smart RV system
- Bluetooth ceiling & exterior speakers
- 60X80" residential queen bed
- 50-amp service is standard on all GSL fifthwheels

2024 Starcraft GSL 5th Wheel



Starcraft 264RLS 6,680 lbs.

\$69,995 ***\$586 per month



Starcraft 364BHS 11,025 lbs.

\$69,999 ***\$586 per month

2024 Keystone Arcadia 5th Wheel

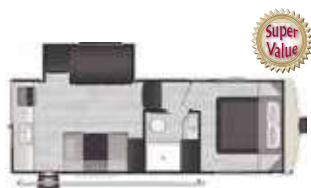

Arcadia Select 21SRK 6,850 lbs.

\$37,991 ***\$318 per month

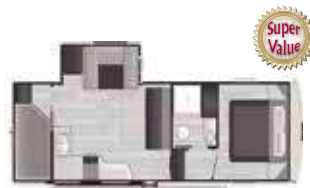

Arcadia Select 275BH 5,000 lbs.

\$38,991 ***\$327 per month



Arcadia 253SLRD 7,620 lbs.

\$45,991 ***\$395 per month

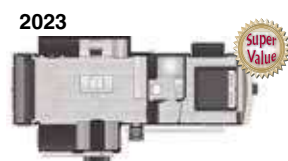

Arcadia 292SLRL 8,935 lbs.

\$54,991 ***\$461 per month



Arcadia 288BH 8,795 lbs.

\$49,991 ***\$417 per month



Arcadia 294SLRD 9,035 lbs.

\$56,250 ***\$476 per month

Arcadia 5th Wheel Advantages over the Competition

- Super strong frame with center spine for optimal structural integrity.
- HyperDeck water resistant composite floor, one of the most durable and well insulated in its class.
- Slide outs with floor flush linoleum instead of carpet
- Revolutionary NGC2™ Next Generation Crawlspace Chassis
- Peak weather protection with 2 layers of roof insulation and 1 layer of reflective foil insulation
- Coleman 15K BTU ducted ultra quiet Coleman Mach Q-Series A/C & residential filter
- 107 gallons of total fresh water capacity
- Fully enclosed, insulated and heated holding tanks
- 12-volt heat pads on all holding tanks
- Dexter Nev-R-Adjust electric brake system
- Extra-wide 30" entrance door w/ friction hinge
- 1-piece AlphaPly™ TPO membrane (lifetime limited warranty)
- Door-side, quick-connect external spray port
- A combination city water fill and power fresh tank fill connection, eliminating slower gravity fill option
- "On Demand" tankless water heater

Sprinter 5th Wheel Advantages over the Competition

- 2" thick High Gloss sidewalls vs 1 1/2" on competitors 25% thinner walls
- 100" Wide Body Construction – wider aisles, larger sofas, etc
- Full profile height fifth wheel at mid profile weight and price= taller slide
- DynaSpan Floor-25-year Warranty – same floor used in high end boating industry
- Commonly stocked 4 points leveling system
- Road Armor Suspension System & Pin Box-smoother towing
- Free Standing Legless Dinette w/built in storage & extension Thermal Package-
- Largest freshwater tank in its category – 81 gallons
- Max Turn Radius Front Cap with patented Hitch Vision
- 2nd Air Standard
- Woven interior flooring eliminates carpeting and makes cleaning a breeze
- 200-watt solar panel with capabilities of upgrades
- 3 Year Structural Warranty

Sprinter Limited Upgrades

- 15.3 CU FT Residential refrigerator with 1000- watt inverter with powered electrical outlets (best in class)
- Solid Surface Countertops
- 70x80 King Bed
- Washer/Dryer Prep Front Closet on same side for easy access
- Roller Shades and upgraded interior features

2024 Keystone Sprinter Limited 5th Wheel



Sprinter Limited 3900DBL 12,500 lbs.

\$76,995 ****\$568 per month



Sprinter Limited 3810QBS 13,500 lbs.

\$76,995 ****\$568 per month

*Financing figured with 15% down plus tax, title and license WAC for 120 Months at 8.49% **Financing figured with 15% down plus tax, title and license WAC for 144 Months (Some inventory over \$50,000 may qualify for 240 months) at 8.49% ***Financing figured with 15% down plus tax, title and license WAC for 180 Months at 8.49%. ****Financing figured with 15% down plus tax, title and license WAC for 240 Months at 8.49%. See your sales associates for more details*

2024 Alpine Avalanche Edition

Advantages over the Competition

- 10" I-beams w/Z-frame technology & 100" wide-body
- Road Armor shock absorbing suspension & hitch pin
 - o Smoother towing experience & less road wear on your trailer
- Laminated sidewalls w/double welded aluminum construction & double insulated rear-end wall
- Painted fiberglass cap w/key shield protection
- Radius roof w/5" pre-engineered roof trusses & walkable rafters
- 1-piece Alpha Super Flex TPO membrane
- Summit slide-rooms w/ 6'10" interior height!
 - o Hydraulic selector valves for slide outs
- In-house climate testing chamber gives Keystone the ability to ensure quality
- Polar Pack protection for four-season camping
 - o Heated and enclosed underbelly
 - o Astro foil reflective layer on roof, front, and rear walls
 - o Two static attic vents
 - o Insulation in the floor wrapped in Darco protective fabric
- Avalanche tested down to -4 degrees and up to 104 degrees
- 7k Dexter axles w/Nev-R-Adjust brakes
- Heavy duty G-rated tires
- Titan Automatic Hydraulic Leveling System
 - o Updated touch screen w/single sensor for leveling
 - o Low-profile footpad – provides better traction
 - o 1/3 the weight of competition's systems
 - o High-impact lighting for early morning or late-night travel days
 - o Syncs with Lippert One Control app
- 150CuFt of heated basement storage
- Class "A" style, dual latch slam baggage doors
- Fully enclosed and heated water convenience center
- Dual 15,000 BTU AC units
 - o Blade Pure airflow system
 - o 20% more cooling power
 - o Air filtration – MERV 9 rated
 - o Sound dampening – 10-15 decibels less than competition
- 35k BTU gas furnace
- Fully programmable dual zone temperature control
- 20CuFT 12V fridge
 - o Higher efficiency than 2-way fridge
 - o Runs off battery during travel
 - o Cools in 2-3 hours vs waiting overnight
- 30" residential microwave
- Hardwood slide out fascia, cabinet doors and drawer faces
- Blackout Roller Shades
- Solid surface counters
- King Bed Standard
- Solar Flex 220 – Standard
 - o 220 watts of roof mounted solar
 - o 30amp Victron MPPT charge controller
 - o Inverter prep
 - o Inverted loop prep (up to 7 outlets on inverted loop)
 - o Zamp side solar port

2024 Alpine Avalanche Edition

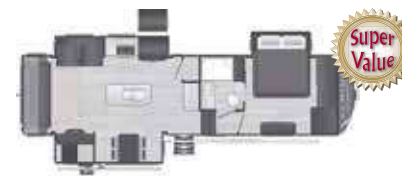

Avalanche 302RS 11,845 lbs.

\$71,991 ****\$531 per month

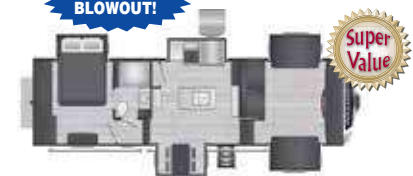

Avalanche 360FL 13,875 lbs.

\$67,991 ****\$495 per month



Avalanche 390DS 14,384 lbs.

\$73,991 ****\$545 per month

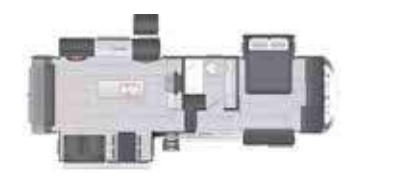

Alpine 3303CK 13,060 lbs.

\$89,295 ****\$659 per month

2024 SportTrek 5th Wheel



Due in March



SportTrek 353VIK 11,210 lbs.

\$74,995 ****\$553 per month



SportTrek 353VRL 11,120 lbs.

\$75,995 ****\$561 per month

2024 SportTrek 5th Wheel

Advantages over the Competition

- BAL NXG Huck Bolted Drop Frame - Powder coated to help prevent rust- largest storage in its class!
- BAL 4-point Electric auto leveling system
- BAL accessory hitch w/ 3000lbs towing capacity and 300lbs of vertical hitch weight
- Dexter heavy-duty axles
- Fiberglass front cap w/automotive paint
 - o Automotive windshield integrated into front cap
- Goodyear Endurance tires
 - o Aluminum wheels w/undermounted full-sized spare
- Best-In-Class 185CuFt heated pass-through storage
 - o Open access between front and basement storage
- Mor-Ryde rubber pin box w/Mor-Ryde CRE 3000 suspension
- Laminated rear wall and side walls w/Azdel
 - o Fiberglass slide out end walls
- Weather-Shield
 - o 360 degree wrapped astro foil
 - o Cut to fit residential block foam insulated side and rear walls
 - o Fully enclosed underbelly w/ forced and radiant heat + 12v heated holding tanks
- Dinette table w/ 2 chairs and 2 versa benches (can be used as coffee tables and more storage!)
- 18" GE Stainless Steel dishwasher
- Solid surface countertops
- Double pantry space w/adjustable shelves & hutch for extra work space (4 large drawers for more storage)
- Tankless on-demand water heater
- 16CuFt 12v side-by-side fridge w/ access to fridge when slides are in
- Campfire Café w/entertainment center
 - o 40" LED smart TV w/swing arm bracket
 - o 110V mini-fridge
 - o Stainless steel sink
 - o Adjustable faucet w/hot & cold water + additional spray hose
 - o Lodge griddle
 - o JBL Flip speaker w/Bluetooth
- 200 watts of roof mounted solar – standard

*Financing figured with 15% down plus tax, title and license WAC for 120 Months at 8.49% **Financing figured with 15% down plus tax, title and license WAC for 144 Months (Some inventory over \$50,000 may qualify for 240 months) at 8.49% ***Financing figured with 15% down plus tax, title and license WAC for 180 Months at 8.49%. ****Financing figured with 15% down plus tax, title and license WAC for 240 Months at 8.49%. See your sales associates for more details*

2024 Brinkley

Reserve your new Z Air 295 Travel Trailer now!



Brinkley 2900

\$88,999 ****\$654
per month



Brinkley 3100

14,695 lbs.

\$89,999 ****\$664
per month



Coming in March



Brinkley 3400

13,698 lbs.

\$99,999 ****\$738
per month



Brinkley 3110

12,146 lbs.

\$89,999 ****\$664
per month



Brinkley 3610

14,695 lbs.

\$99,999 ****\$738
per month



Brinkley

Advantages over the Competition

- Mid-high profile - Industry First (79'6" Bedroom Height)
- Azdel exterior walls
- Alpha bond mylar seal on all seams - No caulk to seal
- Skirting metal is riveted vs screws - Best finish in the market
- Maintenance free roof
 - o Industrial gasket seals (same as what is used in houses in Florida)
 - o Additional MS polymer for peace of mind
 - o 25-year warranty on roof membrane
- 370 watts of **standard** roof solar
 - o 50a MPPT Charge controller
 - o Inverter prep with whole coach inversion
- 17.5" h-rated cooper tires with custom rim
- TPMS system with 2.5" screen is **standard**
- 7k axles w/road defense powder coating
- Self-adjusting brakes
- MORryde cre 3000 w/1/2" shackle brackets, bronze bushing and greaseable zirks
- 75gal fresh tank capacity, true 90gal grey and 45gal black
- Electric dump valves w/clear termination tank cover
- Motion sensing under mounted lighting
- 65' retractable water hose reel
- Brass water fittings vs plastic
- Tankless on-demand water heater
- "Junk in the trunk" insulated and heated 48x40x15 rear storage
- Upgraded rear receiver w/ 3000lb towing cap and 300lb carrying cap
- Residential interior that is staple and putty free
- Square residential frameless windows w/9" opening distance
 - o Integrated window screen and insulated blackout blinds
- 16 CuFt 12v fridge with full access when slide out is closed
- Flush-floor main level slide out rooms
- Solid surface counters in kitchen and bathroom
- Cabinet ducted heating w/thermaxflex heat ducts that won't kink or tear
- Water shut-off valves at all fixtures
- One-piece low-profile shower surround w/sliding glass door and quad sprayers
- Stackable washer/dryer prep

2024 Toy Hauler *available to order*



Brinkley 3500

16,967 lbs.

\$169,999 ****\$1254
per month



Brinkley 4000

17,674 lbs.

\$192,384 ****\$1419
per month



Brinkley 3950

16,967 lbs.

\$206,100 ****\$1551
per month

*Financing figured with 15% down plus tax, title and license WAC for 120 Months at 8.49% **Financing figured with 15% down plus tax, title and license WAC for 144 Months (Some inventory over \$50,000 may qualify for 240 months) at 8.49%
Financing figured with 15% down plus tax, title and license WAC for 180 Months at 8.49%. *Financing figured with 15% down plus tax, title and license WAC for 240 Months at 8.49%. See your sales associates for more details*

For the most updated preowned list, see premierrv.com

Revised
12/19/2023



746 Industrial Drive
Blue Grass, IA 52726
(563) 424-7788
premierrv.com

PREMIER RV
746 Industrial Drive
Blue Grass, IA 52726

Stock#	Layout	Sleep	Ext.	Slide	Year	Model	Bed	Air	Awning	UVW	Status	Price
2085	TD	2	AL	0	2024	UkanCamp 590G	TB	0	none	1,235	90 day	12/22/23
2040	BH	4	AI	0	2013	Jayco Jay Flight Swift 154BH	TB	1	manual	3,200	as-is	\$5,995
2060	FK	2	FIB	0	2018	Nucamp T@B 320S Outback	TB	1	none	?	as-is	April
1846	BH	8	AL	1	2022	Forest River Wildwood 178BHSK	MB	1	electric	4,414	90 day	\$19,995
1954	RB	4	FIB	1	2022	Ember Overland 171FB	MB	1	electric	4,165	90 day	\$25,995
1870	RK	4	FIB	1	2018	KZ Escape Mini M181RK	CQ	1	electric	3,020	as-is	\$18,895
2045	FL	2	FIB	0	2021	Nucamp T@b 400 Boondock	CQ	1	none	?	90 day	\$15,991
2061	RB	4	AL	0	2017	Forest River Wildwood X-Lite FSX 186RB	QB	1	electric	3,193	as-is	\$11,990
1736	RB	4	FIB	0	2022	Forest River Flagstaff E Pro E19FD	MB	1	electric	3,294	90 day	\$24,995
1903	BH	6	FIB	1	2022	Forest River R-Pod 193	CQ	1	electric	3,766	90 Day	\$21,995
2022	RB	2	FIB	1	2020	Keystone Passport Express 199ML	MB	1	electric	4,300	90 day	\$18,995
1352	RB	4	FIB	1	2022	Venture RV Sonic 220VRB	QI	1	electric	4,710	as-is	\$28,995
1906	RB	2	FIB	1	2021	Forest River Rockwood 2205S	QI	1	electric	5,192	90 day	\$26,395
2010	RB	2	FIB	1	2023	Starcraft Super Lite 225CK	QI	1	electric	5,090	90 day	\$27,595
1833	RL	4	FIB	1	2019	Cherokee Alpha Wolf 23RD-L	QI	1	electric	5,448	as-is	\$25,995
1937	BH	7-8	FIB	1	2003	Aero Lite Cub C236	Q	1	manual	3,720	as-is	\$4,995
1944	RB	6	FIB	1	2013	Jayco Jay Feather 24T	QI	1	electric	4,634	as-is	\$13,995
1545	RB	4	FIB	1	2021	Forest River Micro Lite 25BSDS	QI	1	electric	5,894	90 day	\$31,950
1622	RB	6	FIB	2	2017	Keystone Bullet Premier 26RBPR	QI	1	electric	5,930	as-is	\$24,995
1773	RL	6	FIB	1	2018	Keystone Bullet 269RLS	QI	1	electric	5,360	as-is	\$25,995
1863	BH	10	AL	0	2018	Cherokee Grey Wolf 26BH	QI	1	electric	4,448	as-is	\$13,895
1958	BH	10	FIB	1	2023	Starcraft Autumn Ridge 26BHS	QI	1	electric	4,710	90 day	\$23,991
1534	RB	4	FIB	1	2021	Jayco Whitehawk 27RB	QI	1	electric	7,095	90 day	\$34,995
1739	BH	8-10	FIB	1	2020	Venture RV Sporttrek 270VBH	QI	1	electric	6,020	90 day	\$27,995
1959	BH	10	AL	1	2021	Keystone Hideout 272BH	QI	1	electric	6,090	90 day	\$20,795
1964	RE	?	FIB	3	2017	Forest River Hemisphere GLX 299RE	QI	?	electric	7,243	as-is	\$27,995
1911	BH	11	AL	2	2020	Keystone Hldeout 318LHS	QI	1	electric	7,650	90 day	\$24,995
1842	RL	4	FIB	3	2020	Heartland Mallard M335	QI	1	electric	8,298	90 day	\$29,995
1930	RK	?	FIB	2	2018	Keystone Cougar Half Ton 33MLS	QI	?	electric	8,040	as-is	\$29,995

Fold Downs

Stock#	Layout	Sleep	Ext.	Slide	Year	Model	Bed	Air	Awning	UVW	Status	Price
1967	FD	4	FIB	0	2014	Forest River Hard Side A122S	F&T	?	?	?	as-is	\$8,590

Toy Hauler Trailers

Stock#	Garage	Sleep	Ext.	Slide	Year	Model	Bed	Air	Awning	UVW	Status	Price
1902	14	4	AL	0	2020	Forest River Grey Wolf 25RRT	QI	1	electric	5204	90 day	\$21,995
1694	11	6	AL	1	2017	Forest River Cherokee Grey Wolf 27RR	QI	1	electric	5706	as-is	\$18,995

Toy Hauler Fifth Wheels

Stock#	Garage	Sleep	Ext.	Slide	Year	Model	Bed	Air	Awning	UVW	Status	Price
1905	10	6	FIB	3	2014	Heartland Cyclone 3110	QI	2	electric	13120	as-is	\$37,795
1866	12'	9	FIB	3	2019	KZ Venom 4012TK	QI	3	electric	14900	90 day	\$72,995

Fifth Wheels

Stock#	Layout	Sleep	Ext.	Slide	Year	Model	Bed	Air	Awning	UVW	Status	Price
1787	RL	4	FIB	2	2022	Grand Design Reflection 280RS	QI	2	electric	8,556	90 day	\$54,795
1909	RK	6	FIB	2	2006	Cedar Creek Silverback 29RLRGS	QI	?	manual	9,530	as-is	\$10,990
1966	RL	?	FIB	3	2016	Keystone Sprinter 298FWRLS	QI	?	electric	9,800	as-is	\$27,590
1877	RL	4	FIB	3	2006	Cedar Creek Silverback 30LSTS	QI	?	manual	10,009	as-is	\$9,899
1764	RE	6	FIB	3	2017	Keystone Hideout 315RDTs	QI	1	electric	9,470	as-is	\$33,595
1929	RL	4	FIB	3	2019	Keystone Montana 3120RL	QI	2	electric	12,050	90 day	\$49,995
1876	RE	4	FIB	3	2013	Heartland Sundance 3270RES	QI	1	electric	10,616	as-is	\$19,995
2032	RL	4	FIB	3	2017	Coachmen Brookstone 325RL	QI	2	electric	12,302	as-is	\$42,995
1925	RL	4	FIB	3	2000	Nuwa Hitchhiker Discover 35LKTG	QI	?	manual	10,660	as-is	\$4,995
2037	RL	4	FIB	3	2012	Jayco Eagle 351MKTS	QI	?	electric	11,524	as-is	\$19,995
1845	FL	6	FIB	6	2021	Forest River Sierra 379FLOK	?	2	electric	13,235	90 day	\$61,995

Motorhomes

Stock#	Layout	Sleep	Ext.	Slide	Year	Model	Bed	Air	Awning	UVW	Status	Price
2033	B	4-Mar	FIB	1	2013	Winnebago View 24V	TB	1	electric		as-is	\$72,995

Layouts: RL=rear living , RE=rear entertainment, BH=bunk house, RK= rear kitchen, RB=rear bath, FL=front living , FK=front kitchen, TD=Teardrop, FB=Front Bath

Bed: QI = queen island , KI - king island, CQ - corner queen , CD - corner double, QRS = queen rear slide, QFO = queen foldout, MB = Murphy Bed

Disclaimer - all information and weights are approximate. Not responsible for errors in information, weights and pricing. See Salesperson for complete information.

PRST STD
U.S. POSTAGE
PAID
Permit No. #62
Rock Island, IL

**Financing figured with 15% down plus tax, title and license WAC for 144 Months. See your sales associates for more details*